

*H Series shown with RA Base (HRA)
#1 Classic molding, and optional corbels
(48" – 60" wide will have 2 center panels)*

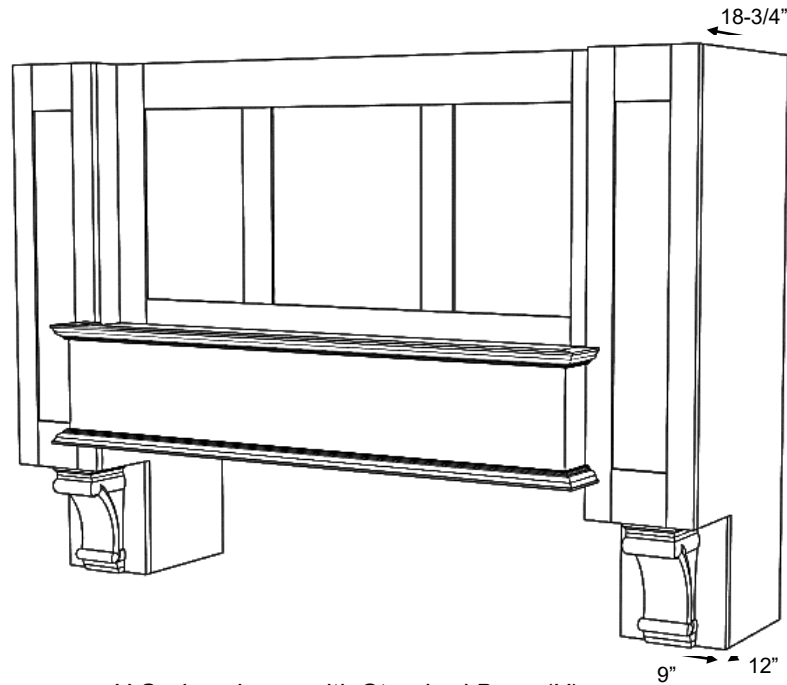

*H Series shown with Standard Base (H)
#1 Classic molding, and optional corbels
(66" – 78" wide will have 3 center panels)*

H Series

Standard Widths	48, 54, 60, 66, 72, 78 (Reduced widths available) To calculate minimum width, take range width plus 18". Example: A 36" range would get a 54" wide hood. (36 + 18 = 54)
Standard Heights	38, 44, 50, 56, 62 (Reduced heights available) To calculate height, take ceiling height minus 52". Example: A 96" ceiling would have a 44" tall hood. (96 - 52 = 44)
Removable Options	Removable Panel is standard (MRP) 2" fixed top rail available by request (MRP-2TR) – see modifications section.
Ventilation	Hood must be a minimum of 18" wider than available vent width. Example: To use a 36" vent model, the hood should be a minimum of 54" wide
Available Moldings	#1 Classic, #2 Simple, #3 Basic
Available Options	Corbels - All Stanisci corbel options will fit this design (See corbel options page)
Grain Direction	Vertical (Base is horizontal)

Standard Heights: 38, 44, 50, 56, 62

H- Standard Base

H 48
H 54
H 60
H 66*
H 72*
H 78*

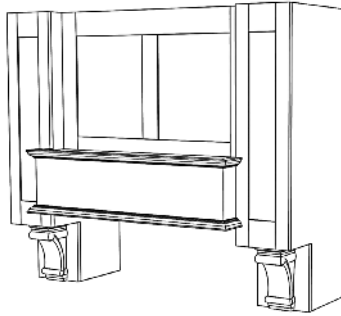

H- Hardwood Base

HHW 48
HHW 54
HHW 60
HHW 66*
HHW 72*
HHW 78*

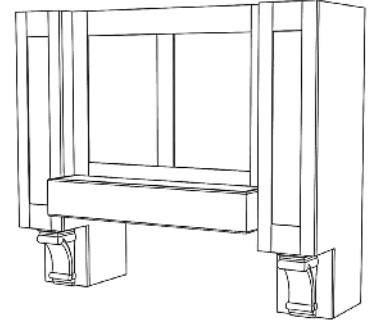

H- RS Base

HRS 48
HRS 54
HRS 60
HRS 66*
HRS 72*
HRS 78*

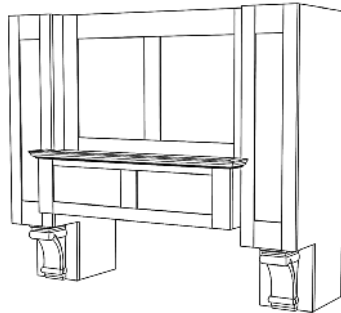

H- RSS Base

HRSS 48
HRSS 54
HRSS 60
HRSS 66*
HRSS 72*
HRSS 78*

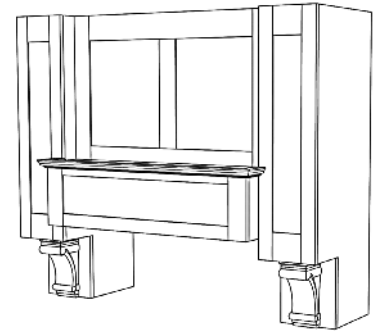

H- RA Base

HRA 48
HRA 54
HRA 60
HRA 66*
HRA 72*
HRA 78*

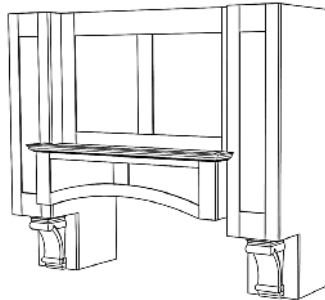

H- DP2 Base

HDP2 48
HDP2 54
HDP2 60
HDP2 66*
HDP2 72*
HDP2 78*

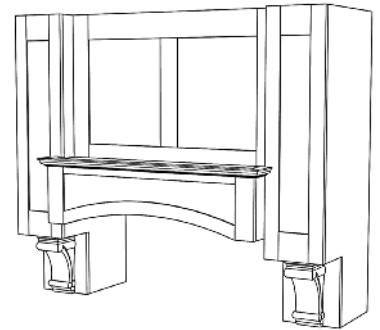

H- SL Base

HSL 48
HSL 54
HSL 60
HSL 66*
HSL 72*
HSL 78*

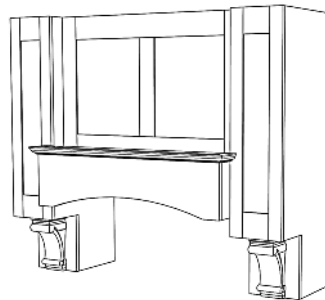

H- DP1 Base

HDP1 48
HDP1 54
HDP1 60
HDP1 66*
HDP1 72*
HDP1 78*

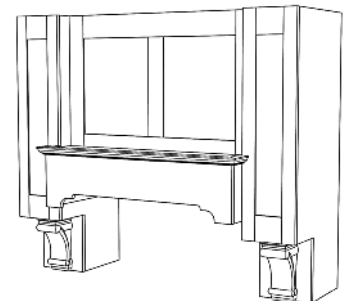

* Top center panel is three panels rather than two, due to width of hood.